



Competition Guide

2013 UCI BMX Supercross World Cup

Manchester (Great Britain)

19 - 20 April 2013

CONTENTS

1. WELCOME & INTRODUCTION 3

2. GENERAL INFORMATION 4

3. REGISTRATION 5

4. TEAM BIBS 8

5. RIDER ACCREDITATION 8

6. EVENT SCHEDULE 9

7. TEAM AREA / TENTS 10

8. UCI OFFICIALS 11

9. TRAVEL & ACCOMODATION INFORMATION 12

10. USEFUL INFORMATION 15

11. ABOUT MANCHESTER 20

APPENDIX 1 – TRACK DESIGN 21

APPENDIX 2 – VENUE LAYOUT 22

APPENDIX 3 - TEAM AREA BOOKING FORM 23



1. WELCOME & INTRODUCTION

On behalf of British Cycling, UK Sport and Manchester City Council I am delighted to welcome you to the National BMX Centre in Manchester for the opening round of the 2013 UCI BMX Supercross World Cup.

We're proud to be bringing the best BMX racing in the world back to Great Britain for what will be the third major international competition to take place on these shores in 12 months, following the 2012 UCI BMX World Championships in Birmingham and the London Olympic Games.

2013 will be the first time the UCI BMX Supercross World Cup has visited the National BMX Centre, the largest indoor BMX track in Europe. Since opening in 2011, the centre has been providing Great Britain's BMX athletes with world class training and competition facilities as well as making BMX accessible to everyone in Greater Manchester and beyond, from grass roots level upwards. We hope that the chance for people to see the world's best BMX riders competing on home soil once again will continue to inspire the next generation of BMX riders to get involved with the sport.

This competition guide should give you all the information you need for a successful and enjoyable competition but if you require further information or have any questions please contact the organising team on bmxsupex@britishcycling.org.uk.

Finally, on behalf of British Cycling I would like to thank everyone who has dedicated their time and resources to making this event a success - the riders, teams, hard-working officials, sponsors and the volunteers, without whom this event would not be possible.

Thank you for being part of what we anticipate will be a fantastic event. We look forward to welcoming you to Manchester.

Jonny Clay

A handwritten signature in black ink, appearing to read 'Jonny Clay'.

Event Director

British Cycling



2. GENERAL INFORMATION

The UCI BMX Supercross Manchester will take place at the National Cycling Centre in Manchester's Eastlands area. The facility is a fantastic purpose built indoor BMX track and sits alongside Manchester's famous velodrome as the home of British Cycling.

The venue is situated in the Sport City complex adjacent to the junction of A6010 Alan Turing Way and A662 Ashton New Road. Please note that ALL road direction signs are for the National Cycling Centre.

National Cycling Centre
 Stuart Street
 Manchester
 M11 4DQ
 England

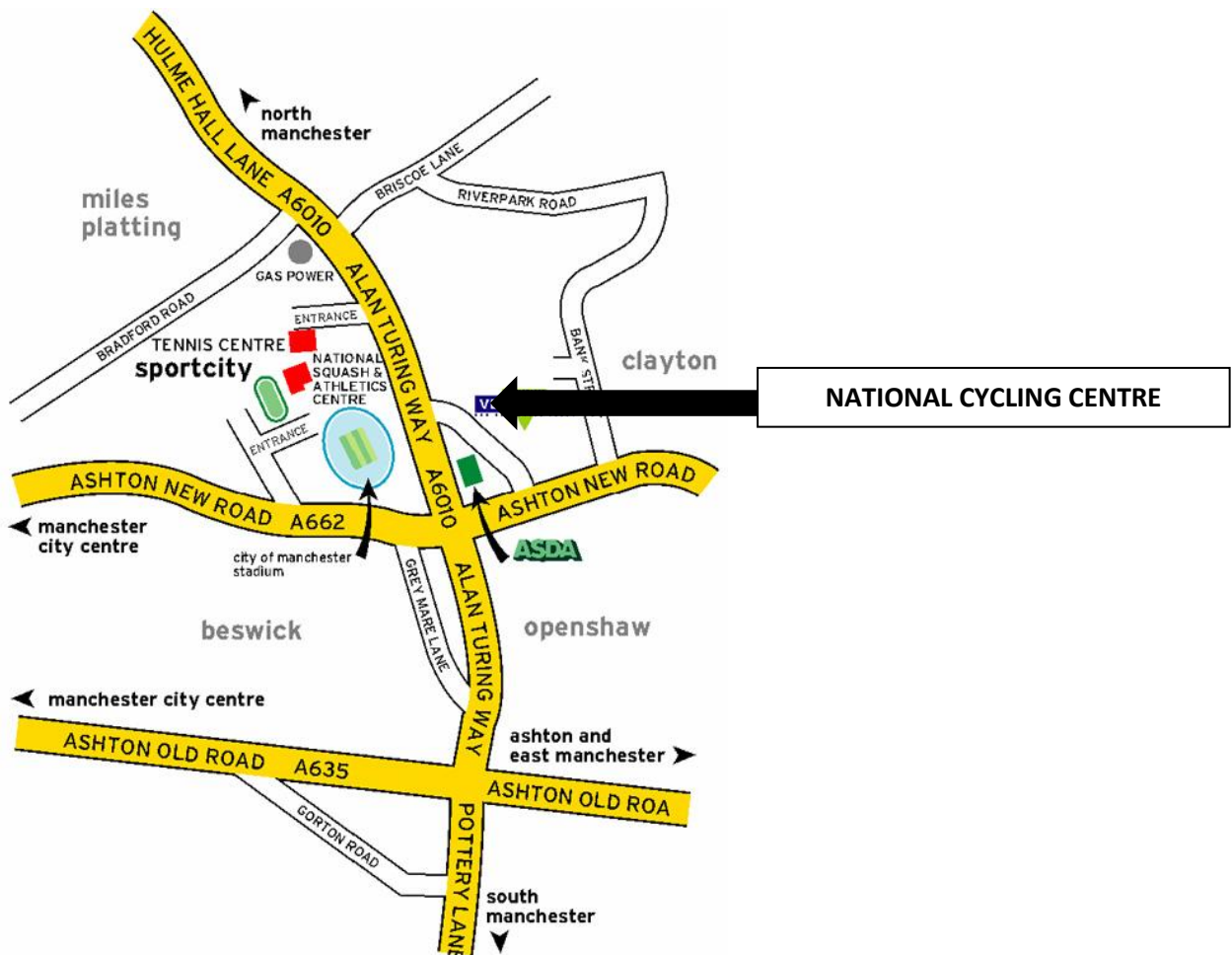

3. REGISTRATION

You can enter through the UCI website clicking as follows:

- **Web services** (on the homepage on the right side, last link)
- **UCI World Cups**
- **Riders registration**

Access: personal login and password of each National Federation.

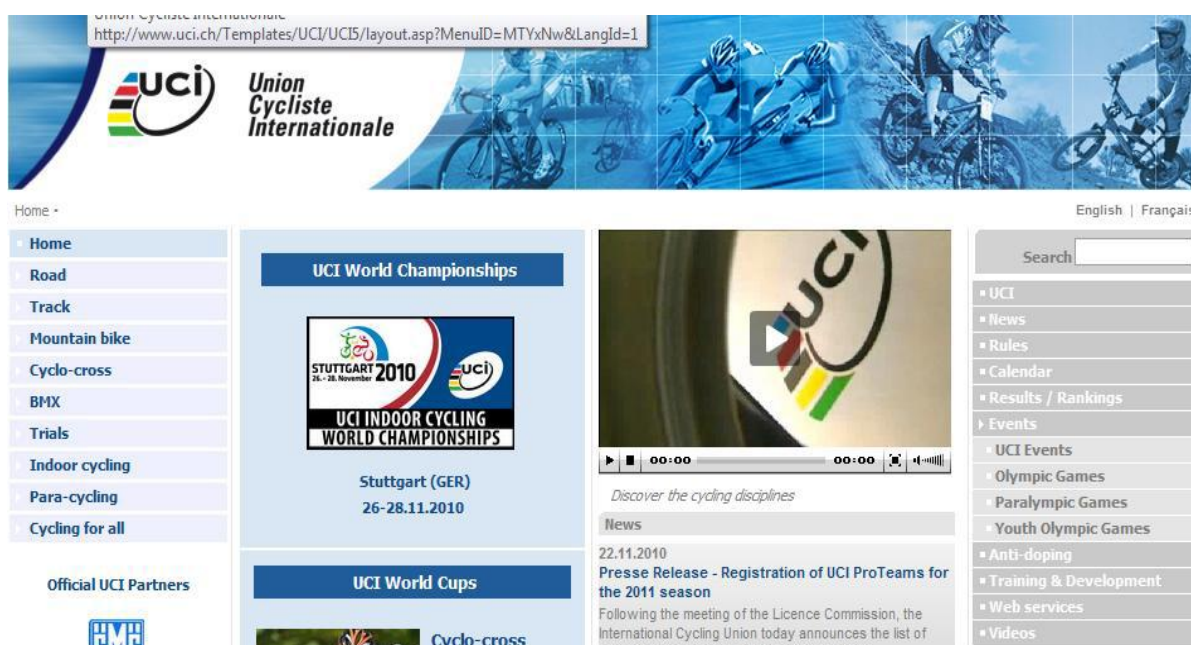

All riders must enter through their national federation; no individual entries will be accepted. Only Junior and Elite riders can participate at the UCI BMX Supercross World Cup. The registration deadline for the Manchester round is 11th April 2013.

<http://www.uci.ch/Modules/BUILTIN/getObject.asp?MenuId=MTUxMzk&ObjTypeCode=FILE&type=FILE&id=ODIxNTA&LangId=1>

The name of the hotel where the Elite riders will overnight must be given during the online registration.

The entry fee for the UCI BMX Supercross World Cup is €125 for online registration. There is a possibility to prepay the invoice or to pay on site. In case of prepayment, the receipt needs to be taken to the competition.

All riders/teams must attend the rider confirmation on the first practice day (Thursday) between 09.00 and 11.30 presenting their licence and picking up their race numbers.



Riders not being confirmed before the indicated deadline did not complete the registration procedure and will not be able to compete at the event.

Late registration is only possible through the National federation and until the rider's confirmation on site, the first training day between 09.00 and 11.30. The entry fee for a late registration is € 250 and should be paid immediately on site. Late entries are entries handled **after** the online registration deadline and **before** the riders' confirmation deadline. Once passed the riders' confirmation deadline no more late entries will be accepted.

Rider confirmation and late registration will take place in the Boardroom at the National Cycling Centre (please see venue plan in Appendix 2).

Team managers need to pay the entry fee for all riders of their nation during riders confirmation. It's mandatory for team managers to collect the number plates of all riders of their nation. No exceptions will be accepted.

Riders that were registered through the online system but that are unable to participate will need to pay their entry fee to the organiser.

BANK ACCOUNT

Entry fees are handled by the Organizing Committee.

| | |
|--------------------------|------------------------|
| Bank account name: | British Cycling Events |
| Bank Account Number: | 10017078 |
| Sort Code: Bank address: | 402080 |
| Swift No: | MIDLGB22 |
| IBAN: | GB06MIDL40208010017078 |

Manchester Cup Racing

The Manchester Cup comprises of three additional events scheduled to take place on the Friday evening alongside the Super Time Trial Finals which are open for rider entries.

- 1) 8 Metre Manchester Cup – Male 17+ Yrs
- 2) 5 Metre Manchester Cup – Male 15/16 Yrs
- 3) 5 Metre Manchester Cup – Female 15+ Yrs

1) 8m Manchester Cup - Supercross Racing

There is an opportunity for all riders who do not qualify from the time trial to race from the 8m ramp in the Manchester Cup that evening.





Riders may enter this event at confirmation on the first practice day when payment details will be collected but only processed after the Time Trial. Alternatively registration can be done after the Time Trial is complete for a short period.

The entry fee is £25 GBP with prize money for the top 8 positions.

| Place | £ |
|-------|-----|
| 1st | 350 |
| 2nd | 275 |
| 3rd | 225 |
| 4th | 150 |
| 5th | 100 |
| 6th | 50 |
| 7th | 25 |
| 8th | 25 |

Entry is open to all elite racers (17+ yrs) who do not qualify for the Supercross racing on Saturday 20th April. To maintain the entry to the UCI BMX Supercross World Cup any rider finishing in the top 64 of the Time Trial and subsequently racing the next day are not permitted to enter.

2) & 3) 5m Manchester Cup Racing

The Friday evening will also host 15/16 (male) and 15+ (female) race from the 5m hill.

Open to riders from any country with a 2013 international licence (To maintain the entry to the UCI BMX Supercross World Cup any rider finishing in the top 64 of the Time Trial and subsequently racing the next day are not permitted to enter)

Entry is via the British Cycling Entry System here: [online](#)

Entries open: 8th March

Entries close: 12th April

(Late entries accepted until 17th April at double fee)

The entry fee is £25 GBP with prize money for the top 8 positions.

| | 5m Men | | 5m Women | |
|-------|--------|--|----------|--|
| Place | £ | | £ | |
| 1st | 125 | | 125 | |
| 2nd | 80 | | 80 | |
| 3rd | 65 | | 65 | |
| 4th | 50 | | 50 | |
| 5th | 25 | | 25 | |
| 6th | 25 | | 25 | |
| 7th | 10 | | 10 | |
| 8th | 10 | | 10 | |





4. TEAM BIBS

Team BIB's will be provided for National teams (1 per nation) by the Secretary during the riders confirmation.

This takes place on the first practice days between 09.00 and 11.30 at the registration room. Teams will be asked to pay €100 or equivalent deposit.

The team BIB's give access to allocated places explained by the PCP during the team managers meeting.

The BIB's need to be returned to the Secretary before Time Trial qualification starts. You will also get the deposit back at that time.

5. RIDER ACCREDITATION

All rainbow passes are delivered to the teams during the first event. If additional sporting passes are necessary the request needs to be send before the event to ellen.bollansee@uci.ch

Rainbow passes will be distributed during rider confirmation in the registration room.

GSX will supply/wristbands/bracelets to all competitors.

6. EVENT SCHEDULE

2013 UCI BMX Supercross World Cup

MANCHESTER, GREAT BRITAIN

Event Schedule

Wednesday 17th April

19.00 - 19.30 Team Manager Meeting

Thursday 18th April

09.00 - 11.30 Rider confirmation & transponder handout

13.00 - 14.25 Elite Men Practice - Group A

14.30 - 15.55 Elite Men Practice - Group B

16.00 - 17.25 Elite Women Practice - Group C

Friday 19th April

10.00 - 10.55 Elite Women Practice - Group C

11.00 - 11.55 Elite Men Practice - Group B

12.00 - 12.55 Elite Men Practice - Group A

Break

13.00 - 13.45 Elite Women Time trials qualification

13.45 - 16.00 Elite Men Time trials qualification

Break (Manchester Cup Practice – Time TBC)

18.00 - 18.15 Warm up Women

18.20 - 18.35 Warm up Men

19.00 - 19.25 Elite Women Time trials Superfinal

19.30 - 20.00 Elite Men Time trials Superfinal

20.00 - 22:30 Manchester Cup Racing

Saturday 20th April

16:00 - 17:00 *Schools racing*

17.00 - 17.45 Autograph session

18.00 - 18.25 Warm up Elite Women

18.30 - 18.55 Warm up Elite Men

19.00 - 19.05 Riders Introduction

19.05 - 20.45 **Elite Men 1/8 Finals 1st round**

Elite Women Quarterfinal 1st round

Elite Men 1/8 Finals 2nd round

Elite Women Quarterfinals 2nd round

Elite Men 1/8 3rd round

Elite Women Quarterfinals 3rd round

Break

20.50 - 21.00 **Elite Men Quarterfinals**

21.05 - 21.15 **Elite Women Semifinals**

21.20 - 21.25 **Elite Men Semifinal**

21.30 - 21.40 **Elite Women Final**

21.40 - 21.50 **Elite Men final**

21.50 - 22.00 Awards ceremony

Event schedule subject to changes

Updated: 05.03.2013



7. TEAM AREA / TENTS

In line with other events in the UCI BMX Supercross series team tents will be available to hire. Please note that although the racing is indoors the team areas are located outdoors.

There are 2 options.

Option 1

Individual spaces in a shared marquee for teams with 2 riders or fewer. This is free of charge but power is not available, there is no vehicle access and car parking is in the organisers car park. This space will be allocated on a first come first served basis and must be booked in advance despite there being no cost.

Option 2

A private tent 3 x 3m (£225 GBP) or 6 x 3m (£450 GBP) with an optional upgrade to include power (£50 GBP). All private tents include 1 premium car parking space to allow teams to park a vehicle close by and a small amount of furniture.

Teams interested in booking a tent may do so by completing the form in Appendix 4 and returning it to bmxsupex@britishcycling.org.uk. The deadline to book a tent is Friday 5th April 2013 to allow arrangements to be made. Tents are non-refundable and payment must be received before number plates are distributed.

Teams are not permitted to bring their own structures.

8. UCI OFFICIALS

| | |
|--|-----------------------|
| UCI Technical Delegate | BOLLANSEE Ellen (BEL) |
| President of the Commissaires' panel (PCP) | KERKHOF Stef (NED) |
| Assistant PCP | MAPP George (GBR) |
| Secretary | GOSLING Carole (GBR) |
| 3rd commissaire | SYKORA Jan (CZE) |
| Doping Control Officer (DCO) | KEOGH Edward (IRL) |



9. TRAVEL & ACCOMODATION INFORMATION

Team Hotel

Holiday Inn Manchester Central Park
888 Oldham Road
Newton Heath
Manchester
M40 2BS

The official accommodation provider CSE have secured special accommodation rates at the Holiday Inn Manchester Central Park for teams and other relative personnel. The Holiday Inn Manchester Central Park is conveniently located less than a mile from the track at the National Cycling Centre and just 2 miles from Manchester City Centre. The modern hotel offers comfortable bedrooms, a bar & restaurant offering a wide range of dining options and 24 hour room service. Guests can also benefit from complimentary onsite car parking & WI-FI access.

To make an enquiry or reservation please contact CSE, or download the booking form [here](#) and return directly to CSE using the contact details below. Requests are subject to availability.

CSE Contact Information

Mandy Bateman:

E: Mandy@CORPORATE-SPORTING.COM, T: (+44) 0121 647 4096

Official Hotel

Park Inn by Raddisson, Manchester
Cheetham Hill Road
Manchester
M4 4EW

Based in the City Centre this hotel is conveniently located opposite the Manchester Arena and Victoria rail and tram stations, and is just a 5 minute walk from a lively shopping district. The modern hotel offers comfortable bedrooms with city views, a Bar & Grill, Gym and 24 hour room service. A convenient nearby pay car park at the NCP Manchester Arena gives a discount to guests with a hotel-validated ticket, guests also benefit from complimentary WI-FI access.





Travel

Transfers from the airport **are not** provided by the LOC, teams are required to make their own travel arrangements to and from the point of arrival

Manchester International Airport

Manchester International Airport is located approximately 11 miles west from the National Cycling Centre. There are no direct links from the airport to the national cycling centre, however regular trains to the city centre are available from the airport, where links are then available direct to the National Cycling Centre. There is also the option for a taxi directly to the National Cycling Centre which would cost approximately £25-£30 sterling depending on traffic conditions.

Car or Van Hire

There are many options for Car or Van hire at Manchester International Airport, options are available on the Manchester Airport official website:

<https://www.cartrawler.com/manchesterairport/?clientID=429456>

Ferry Ports

For those driving to the event in order to transport kit please find below a list of the popular ports and the incoming ferry destinations;

Portsmouth- 240 miles to Manchester:

- Caen, France
- Cherbourg, France
- Jersey
- Guernsey
- Le Havre, France
- Ryde, Isle of Wight
- St Malo, France

Dover- 290 miles to Manchester:

- Calais, France

Liverpool- 35 miles to Manchester:

- Dublin, Northern Ireland
- Belfast, Republic of Ireland
- Isle of Man

Hull-100 miles to Manchester:

- Rotterdam , Netherlands
- Zeebrugge, Belgium

Rail

Manchester city centre has two major train stations, Piccadilly and Victoria. Piccadilly provides a gateway to the south with direct connections to London Euston every 20 minutes with a journey time of 2 hours. Other major cities within an hour's train journey include; Leeds, Liverpool, Preston and Sheffield.



Metrolink

The Metrolink provides a tram directly from either Manchester Piccadilly or Victoria train stations every 15 minutes to the National Cycling Centre site (Velopark).

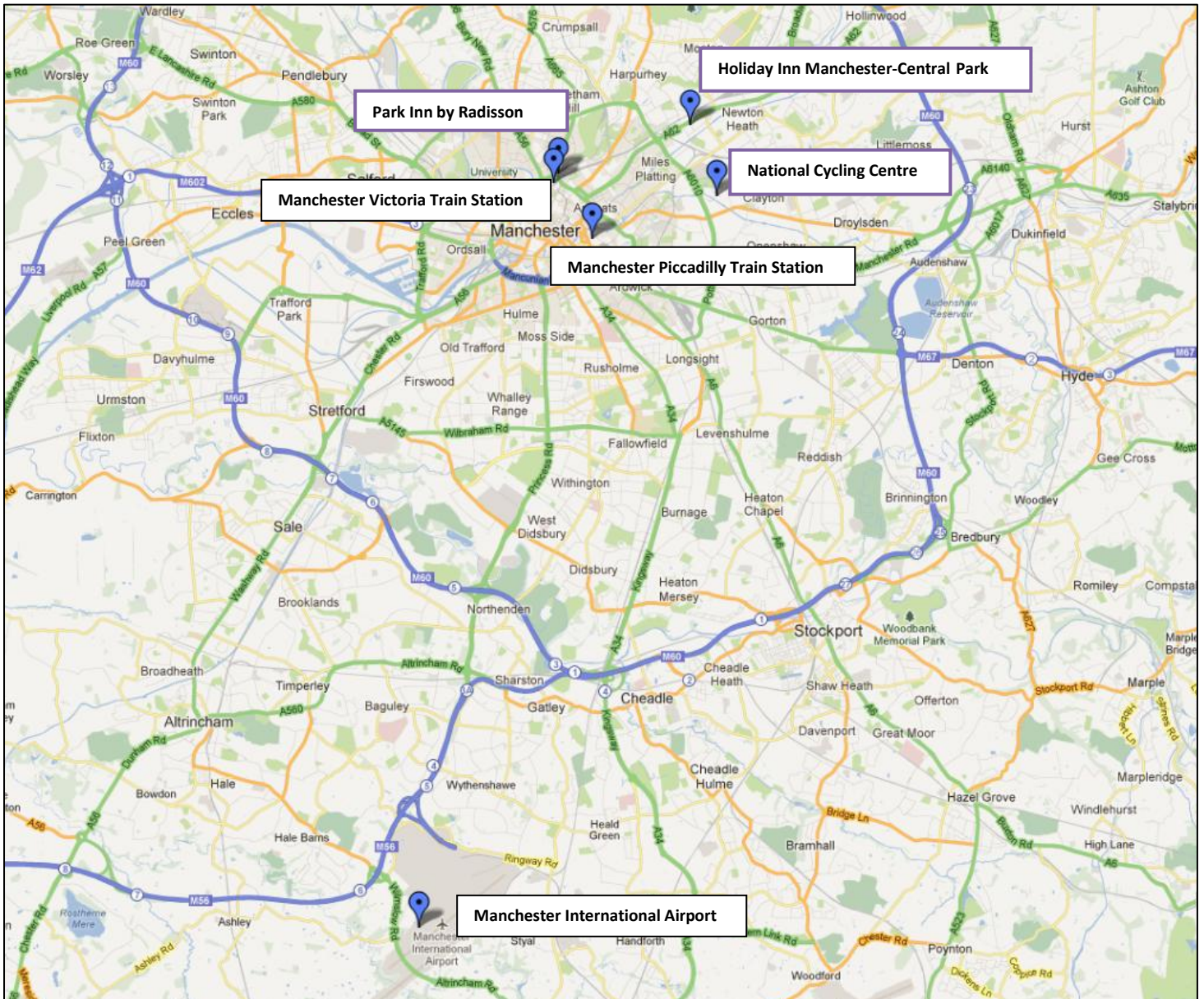

10. USEFUL INFORMATION

Key Contacts

If you need further information about the UCI BMX Supercross World Cup, please contact the following persons:

| | |
|-----------------------------|---|
| Sport & Technical Aspects: | Ellen Bollansée BMX coordinator ellen.bollansee@uci.ch |
| GSX Race Director: | Johan Lindstrom GSX Events johan.lindstrom@gsxevents.com |
| Local Organising Committee: | Phil Heselwood British Cycling philheselwood@britishcycling.org.uk |
| Team Liaison Contact: | Tony Luckhurst bmxsuperx@britishcycling.org.uk |

Team Liaison

The organising committee has appointed a Team Liaison to act as the main point of contact between participants and the organisers. They can be contacted on the email address above and will be available at the event to answer any enquiries.

Anti-Doping

There will be anti-doping tests at the 2013 UCI BMX Supercross World Cup. The tests will be done by a UCI Doping Control Officer and an appointed doctor. For your information, the UCI Anti-Doping policy, rules and prohibited list can be found [here](#).

Visas

Participants from some countries will need to obtain a visa in order to enter the UK. Should this be the case then we will be pleased to provide you with a letter of invitation to the event in support of your visa application.

Should you wish to receive such a letter, please email the following information to bmxsuperx@britishcycling.org.uk

- The full name, nationality, Date of Birth and passport number of each person that requires a visa.
- Whether the person seeking a visa is team staff or a rider participating in the event.

Prize Money UCI Supercross

All prize money shall be available to collection from the accreditation centre at the end of competition, after the podium ceremonies. The UCI will pay overall series prize money by wire transfer to National Federations.

| | MEN ELITE | | WOMEN ELITE | |
|--------------|------------------|-------------------|------------------|-------------------|
| | Per round | Overall | Per round | Overall |
| 1st | EUR 2'866 | EUR 6'000 | EUR 1'500 | EUR 4'000 |
| 2nd | EUR 1'666 | EUR 4'000 | EUR 733 | EUR 2'500 |
| 3rd | EUR 1'000 | EUR 2'500 | EUR 300 | EUR 1'379 |
| 4th | EUR 800 | EUR 1'500 | EUR 267 | EUR 900 |
| 5th | EUR 666 | EUR 1'200 | EUR 233 | EUR 800 |
| 6th | EUR 600 | EUR 1'000 | EUR 200 | EUR 700 |
| 7th | EUR 500 | EUR 800 | EUR 187 | EUR 600 |
| 8th | EUR 400 | EUR 600 | EUR 167 | EUR 500 |
| 9 th | | EUR 550 | | EUR 275 |
| 10 th | | EUR 500 | | EUR 250 |
| 11 th | | EUR 450 | | EUR 225 |
| 12 th | | EUR 400 | | EUR 200 |
| 13 th | | EUR 350 | | EUR 175 |
| 14 th | | EUR 300 | | EUR 150 |
| 15 th | | EUR 250 | | EUR 125 |
| 16 th | | EUR 200 | | EUR 100 |
| Total | EUR 8'498 | EUR 20'600 | EUR 3'587 | EUR 12'879 |

| 1st semi-final | |
|----------------|----------------|
| 5th | EUR 150 |
| 6th | EUR 133 |
| 7th | EUR 100 |
| 8th | EUR 60 |
| Total | EUR 443 |

| 2nd semi-final | |
|----------------|----------------|
| 5th | EUR 150 |
| 6th | EUR 133 |
| 7th | EUR 100 |
| 8th | EUR 60 |
| Total | EUR 443 |



Rider & Team Manager Seating

A small block of basic temporary seating will be reserved for team managers and riders to watch the racing. This will be close to the finish line and will be accessed using an accreditation or wristband. Please note all general seating is being sold on a reserved basis, there will be no access to the reserved spectator seating which is being sold to the general public without a ticket.

Expo Area

The event will feature an expo area which will be open to spectators, participants and the general public and presents a great opportunity to showcase your brand. Areas are available in 3 x 3m (£300 GBP + vat) or 6 x 3m (£500 GBP + vat) sizes. Anyone interested in reserving an area should email bmxsuperx@britishcycling.org.uk.

VIP

Watch world class BMX racing from a premium seating block on the finish straight. The package includes a light buffet, access to a private bar and a souvenir programme. For further information or to reserve a place please email bmxsuperx@britishcycling.org.uk.

Media

All media persons planning to attend the event must be accredited in order to gain access to the venue. To apply for media accreditation please complete the [online form](#) before Friday 5th April 2013. Passes will be available to collect from the Event Information Centre which will be open at the following times.

| Date | Time |
|-------------------------|-------------|
| Wednesday 17 April 2013 | 13.00-19:00 |
| Thursday 18 April 2013 | 09.00-17:30 |
| Friday 19 April 2013 | 08.30-22:30 |
| Saturday 20 May 2013 | 13:00-22:30 |



Medical Cover

A team of doctors and paramedics will be present throughout practice and racing. The team will be based on the track and also have use of a private medical room throughout the event.

The medical team will be available at the following times:

Official Practice Day

Thursday 18th April - 12.00 to 18.00

Competition Days

Friday 19th April - 08.30 to 22.00

Saturday 20th April - 13.00 to 22.00

The nearest hospitals with accident and emergency departments are:

Manchester Royal Infirmary
 Oxford Road
 Manchester
 M13 9WL
 Tel: 0161 276 1234

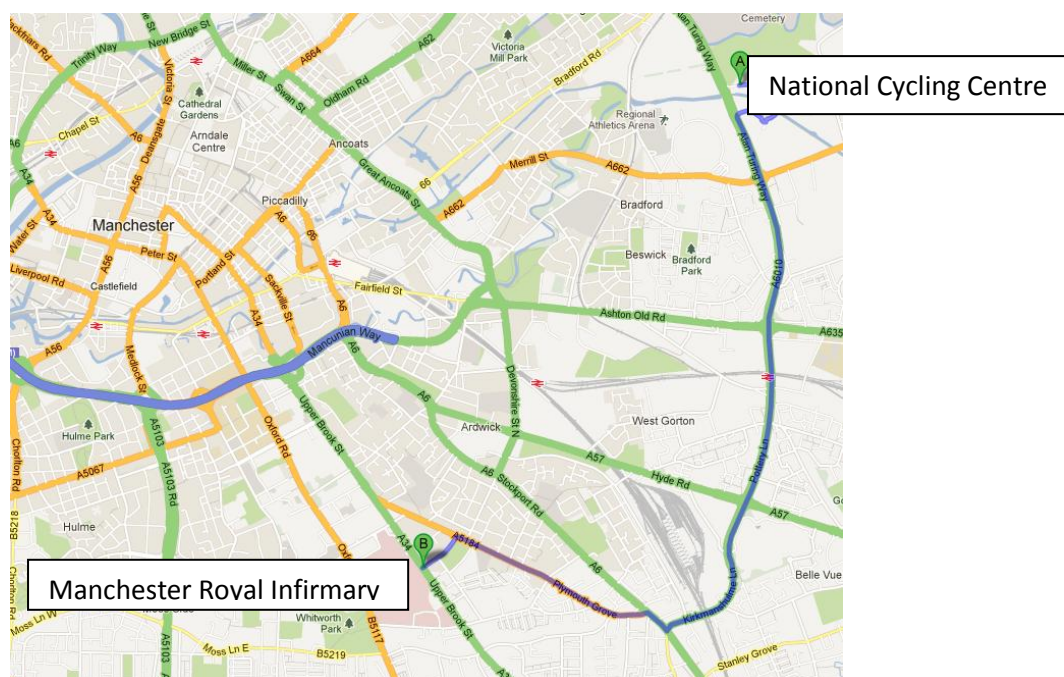

North Manchester General Hospital
 Delaunays Road
 Manchester
 M8 5RB
 Tel: 0161 624 0420

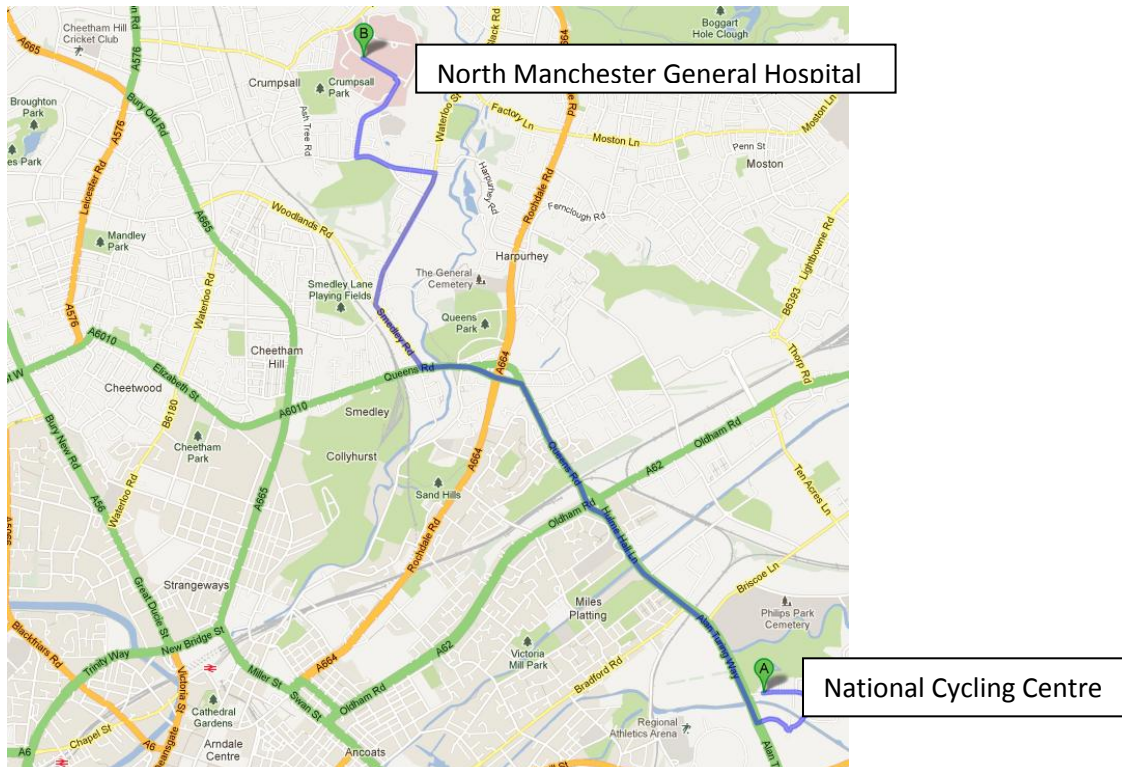

An ambulance is on site to transfer very serious injuries to hospital, we ask that teams help ensure this resource is only utilised in serious circumstances by transferring athletes to hospital in their own vehicles wherever possible.

Social Media & Website

The dedicated 2013 UCI BMX Supercross World Cup Manchester Facebook page will be updated with news and information throughout the event. Become a fan of BMX SuperX on Facebook by clicking [here](#).

Join us on Twitter [@BMXSuperX](#) to keep up with the latest news and results throughout each session.

The official website for the 2013 UCI BMX Supercross World Cup Manchester is www.bmxsuperx.co.uk. It will be continually updated in the run up to the event and throughout the course of the competition.



11. ABOUT MANCHESTER

Manchester is now one of the most successful and well known cities in Europe notably for its architecture, culture, music scene, media links, scientific and engineering output and sporting connections.

Manchester has always been a city renowned for innovation and enterprise, even dating back to the 1800's where Manchester was the first city of the industrial revolution, sparking a pioneering method of manufacturing products which literally changed the world. Keeping with this theme Manchester remained a city of innovation over the generations where the firsts kept coming. The first ever professional football league, the first programmable computer, the first test tube baby and most recently the first purpose built indoor BMX facility.

Manchester is also now well respected for its recent achievements, principally with regards to cycling. Manchester is now the heart of World Cycling, in particular it is well documented as home to the most successful Olympic Cycling team ever that train at Manchester's National Cycling Centre on a daily basis. Furthermore, Manchester is recognised worldwide by millions as home to the most successful and richest football clubs in the prestigious English Premier League, Manchester United and Manchester City.

Manchester's rich sporting heritage is also complimented by a record of consistent high quality sporting events. From the Commonwealth Games to the UEFA Cup Final, the FINA World Championships to the UCI Track Cycling World Championships. Manchester has demonstrated its capacity and appetite to deliver events to the highest standards. Furthermore the city played host to international athletes during London 2012 with Olympic teams including Swim Australia and athletes from Brazil and Thailand. Manchester was also the only city in the North West of England to host an Olympic event with matches in the men's and women's football taking place at the famous Old Trafford football stadium. Manchester has an undisputable passion for sport, one that will ensure that the city's round of the 2013 UCI BMX Supercross World Cup will be the most exciting and entertaining BMX event possible.



APPENDIX 1 – TRACK DESIGN

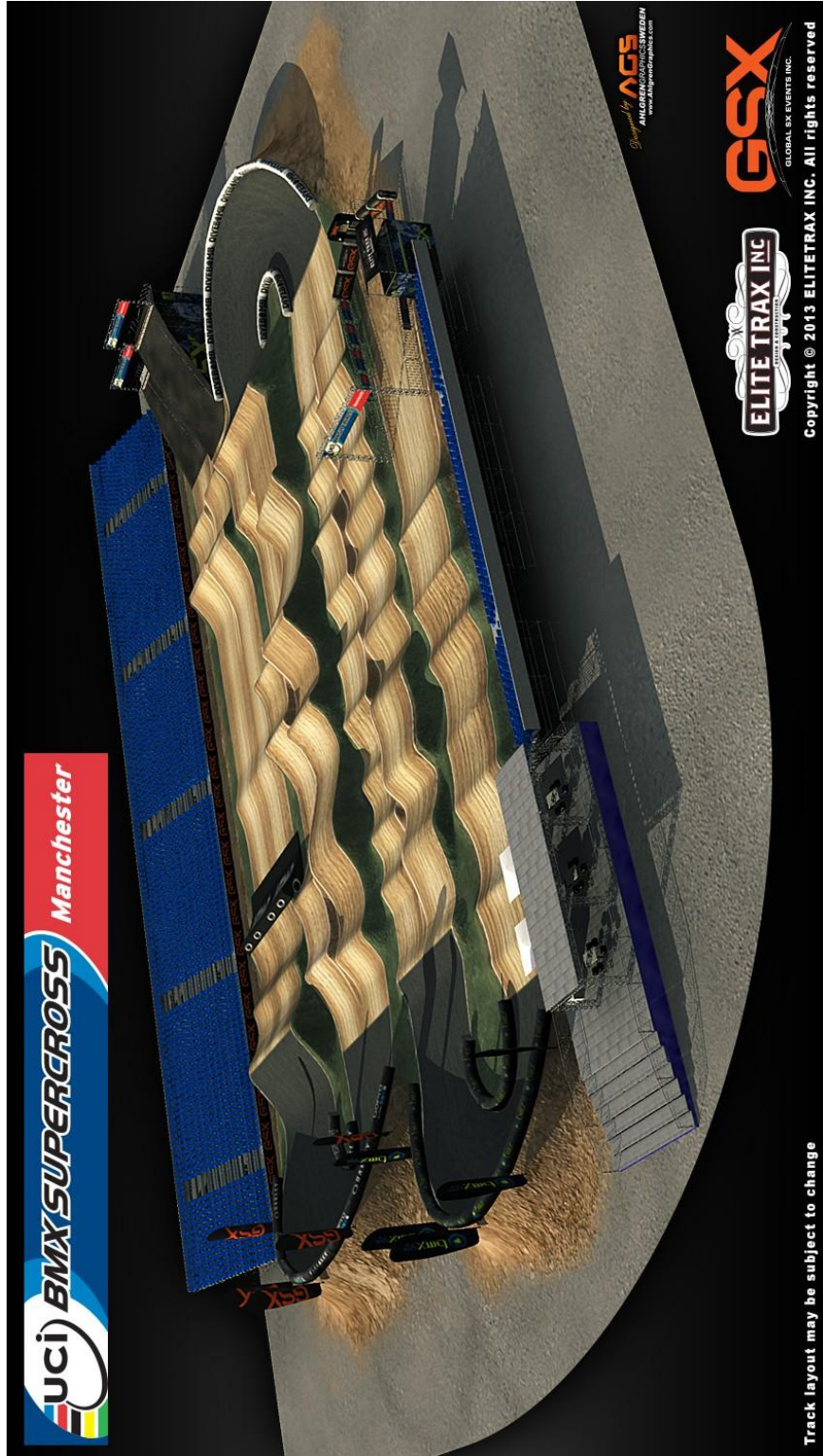

APPENDIX 2 – VENUE LAYOUT

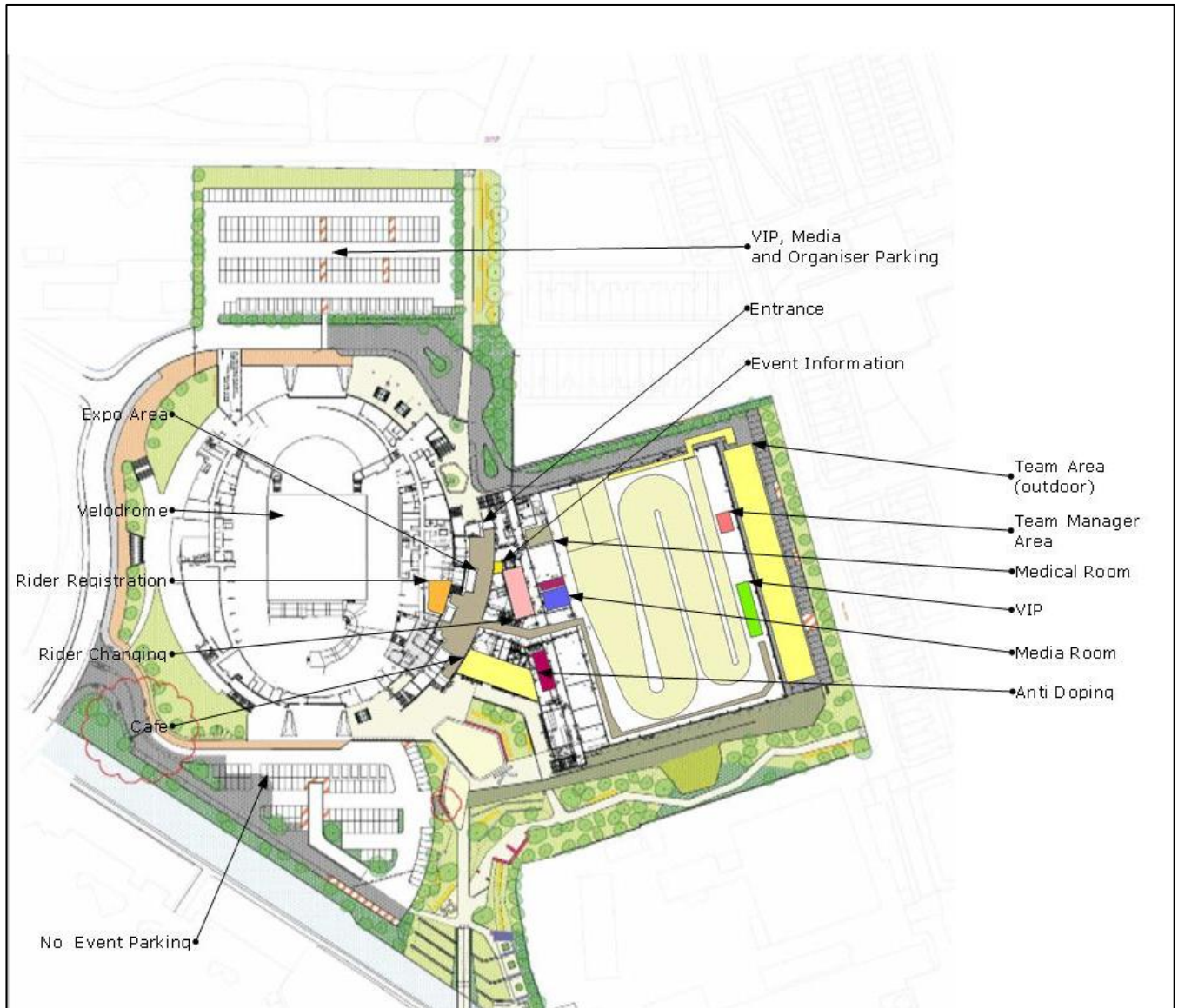

APPENDIX 3 - TEAM AREA BOOKING FORM

Contact Details

| | |
|----------------------------|--|
| NATION/TEAM (For Invoice): | |
| CONTACT NAME: | |
| TELEPHONE (Inc Int Code): | |
| EMAIL: | |
| ADDRESS: | |

Rates

| Size | Cost | Please Tick |
|---|---|-------------|
| Individual space in open marquee | Free Of Charge – Maximum 2 places – unreserved. | |
| 3m x 3m private space + premium parking for 1 vehicle | £225 GBP | |
| 6m x 3m private space + premium parking for 1 vehicle | £450 GBP | |
| Power | £50 GBP | |

The individual team areas that are free of charge are not separated into private areas and do not include power or a premium car parking space. They are only available to teams entering 2 or less riders.

1. The area booked is the maximum space that can be used. Teams must check in with the organisers at the accreditation centre upon arrival at the National Cycling Centre.
2. Vehicle access and parking passes will be allocated according to the area booked.
3. Teams will receive confirmation of receipt of booking form however, final confirmation of space will not be until full payment is received.
4. **Teams that do not pre-book a space will not be able to access the team area and be located away from the centre. Teams will not be able to setup camp in car park areas. Teams are not permitted to bring their own structures.**

Please return completed form to: UCI BMX Supercross World Cup Manchester. British Cycling Events Ltd, Stuart Street, Manchester, M11 4DQ. Fax: +44 (0) 161 274 2001
E-mail: bmxsuperox@britishcycling.org.uk